

Rohner

FINISHING SYSTEMS™

PRECISION FINISHING SOLUTIONS

SPRAY BOOTHS - POWDER BOOTHS - CUSTOM SOLUTIONS

CERAKOTE®

rohnerspraybooths.com

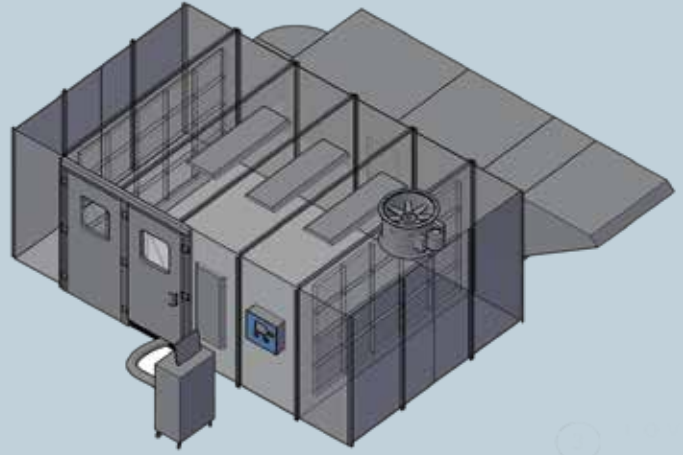

PROUDLY ENGINEERED AND MADE IN THE USA!

- Pre-engineered Cerakote certified booth packages
- C.F.D. computer generated computational fluid dynamic air flow design
- Uniform color correct lighting package
- Seismic engineered structure
- 100% efficient direct fired gas burners
- USA mfg. galvanized steel
- USA mfg. hazardous LED light fixtures
- USA mfg. Exhaust and Makeup air fans
- USA mfg. gas oven burners

CODE COMPLIANT SPRAY BOOTHS

AMCA certified fans with EPACT compliant TEFC motors are standard. Fans have remote bearing lubrication, aluminum spark resistant blades, and heavy duty powder coated housing.

UL 508A listed control packages reduce install cost and are simple to use. Optional controls upgrades can be added to extend filter life and reduce energy consumption.

Booths are designed to meet or exceed NFPA33, OSHA, and IFC Chapter 24 requirements. Consult your local authority having jurisdiction for additional requirements before purchasing.

CERAKOTE®

**CERAKOTE
EXCLUSIVE
2 YEAR
PARTS
WARRANTY!**

PRE-ENGINEERED CERAKOTE MANUAL APPLICATION BOOTHS



ROHNER # CERA-B-443

Cerakote Bench Booth

Dimensions:

Working - 4'-0" W x 4'-0" H x 3'-0" D

Overall - 4'-4" W x 7'-3" H x 5'-2" D

Bench - 4' W x 3' D

Includes:

(1) Enclosed Class I Div. II UL listed LED light fixture

ROHNER # CERA-O-776

Cerakote Open Face Paint Spray Booth

Dimensions:

Working - 7'-0" W x 7'-0" H x 6'-0" D

Overall - 7'-4" W x 7'-2" H x 8'-9" D

Filtered Product Doors (optional) - 7'-0" W x 7'-0" H clear opening

Includes:

(3 - Light) Enclosed Class I Div. II UL listed LED light fixture

OPTIONS

- Additional Lights
- Powder Coat White Finish
- Air Replacement/Heat

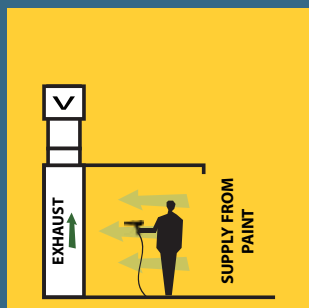
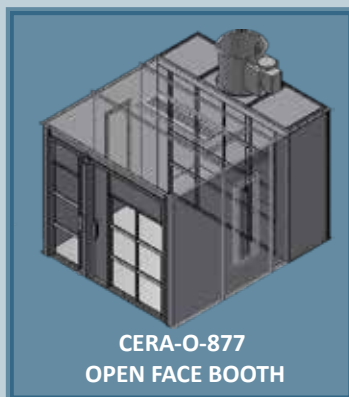

STANDARD FEATURES

- Premium 18 gauge G90 galvanized steel construction
- AMCA certified aluminum blade fans with TEFC motor standard
- UL listed color correct LED light fixtures
- 20 x 20 Industry standard filters
- 100 F.P.M. standard booth velocity
- Welded tube steel product doors
- Easy nut & bolt assembly with 3D exploded view drawings

ROHNER # CERA-R-10812

Cerakote Robotic Spray Enclosure

Dimensions:

Internal - 10'-0" W x 8'-0" H x 12'-0" D

Product Doors - 6'-0" W x 7'-6" H

Robotic Cable Entry - 4" x 4" gasketed

Robotic Swing Certified - Yes

PERFORMANCE

Exhaust: Precision balanced side wall plenum captures maximum overspray

Intake: Filtered opposing wall plenum promotes laminar airflow for improved efficiency

OPTIONS

- Upgraded Light Package
- Pass Through Doors
- Powder Coat White Finish
- Air Replacement/Heat



**CERA-R-10812
ROBOTICS BOOTH**



**CERA-R-10812 W/ OPTIONAL
HEAT AND AIR CONDITION**

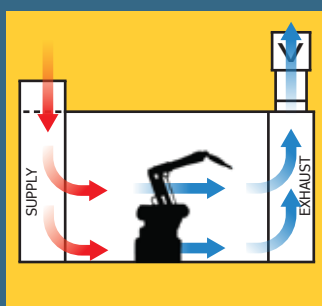

CROSSDRAFT AIRFLOW



**OPTIONAL COMPACT PLC
BASED CONTROL CENTER**

CERAKOTE®

CUSTOM AND MULTI-STATION ROBOTIC CERAKOTE SPRAY BOOTHS

ENGINEERED SOLUTIONS

Rohner engineered solutions work with your production team to design spray booths specific to your production demands. High volume production requirements are met with multi-station manual and robotic spray booths. Booths are configured to meet production output and process flow requirements while maintaining facility layout constraints.

Booth airflow is engineered using CFD (computational fluid dynamic) air flow modeling to promote the highest transfer efficiency and overspray control. Environmental control of temperature and humidity are applied providing consistent paint viscosity, sprayer atomization and part sheen allowing for consistent yearly paint application.

Contact Rohner for an engineered process solution.

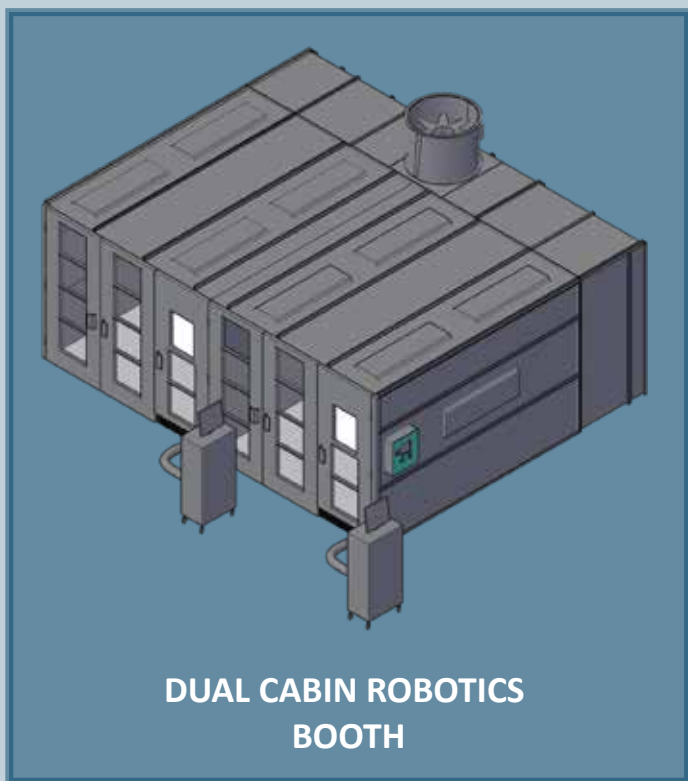

**DUAL CABIN ROBOTICS
BOOTH**

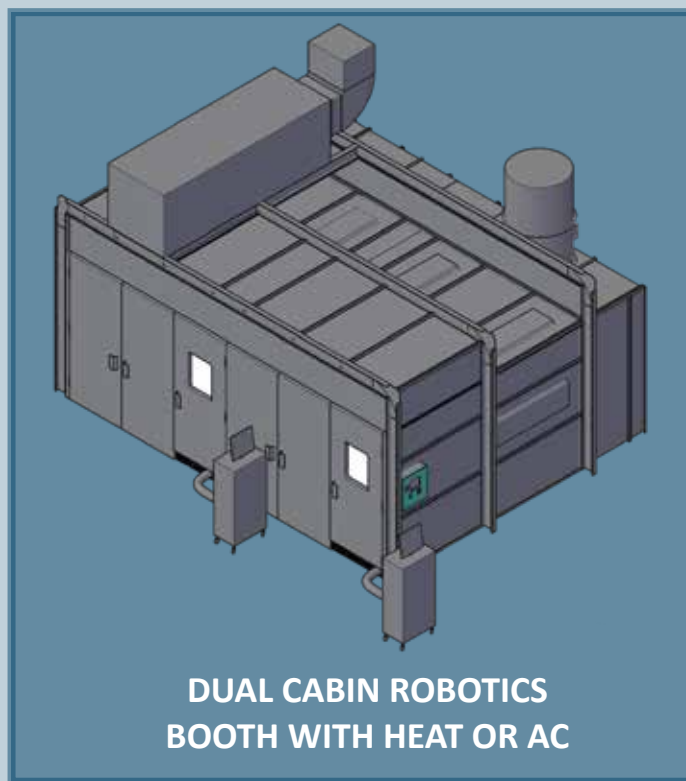

**DUAL CABIN ROBOTICS
BOOTH WITH HEAT OR AC**



BATCH OVEN FOR CERAKOTE APPLICATIONS

OVEN SPECIFICATIONS

- 4" Thick 20ga. aluminized panels insulated with 4lb. density mineral wool. Perforated grooved seams
- Gas fired 25:1 turn-down process heater for precise control
- UL508 industrial control panel with remote HMI touchscreen user interface
- Oven rigidly reinforced with 14-10 ga. galvanized cold formed sheet steel frames sized for seismic design category C. Consult the factory for rigid reinforcement for categories D and for seismic/stamped engineered drawings. (optional: integral booth mounted Process Heater support available).
- NO FIELD WELDING!
- Performance Temperature - 160-450°F (500°F maximum)
- Return Plenum - Return air inlet located at top of process heater
- Discharge Plenum - Two lower side wall plenums will discharge heated air toward the center of the oven creating a mixed flow
- Process Heater - Horizontal or Ceiling Mounted

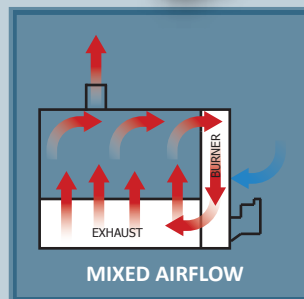

ROHNER # CERA-O-6610

Dimensions:

Working - 6'-0" W x 6'-6" H x 10'-0" D

Product Doors - (1) Set of standard product doors
6'-0" W x 6'-6" H clear opening

ROHNER # CERA-O-8610

Dimensions:

Working - 8'-0" W x 6'-6" H x 10'-0" D

Product Doors - (1) Set of standard product doors
8'-0" W x 6'-6" H clear opening

ROHNER # CERA-O-8910

Dimensions:

Working - 8'-0" W x 9'-0" H x 10'-0" D

Product Doors - (1) Set of standard product doors
8'-0" W x 9'-0" H clear opening

SAFETY STANDARDS

A single 800° Class II industrial plug-blower provides circulation and combustion air resulting in reduced energy and maintenance costs. Rohner Batch Ovens are designed to meet or exceed NFPA86 standards, and their gas trains meet FM insurance requirements. Consult your local authority having jurisdiction for additional requirements before purchasing.



COMPACT PLC BASED
CONTROL PANEL



FILTERED INTAKE AIR

CERAKOTE®

BATCH OVEN FOR CERAKOTE APPLICATIONS

OVEN OPTIONS

- Customizable Dimensions
- Top or Rear Mount Burner
- Natural Gas, Propane, or Electric
- Optional Pass through Doors

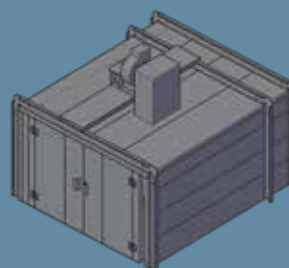

CERA-O-8-6.5-10
REAR MOUNT BURNER

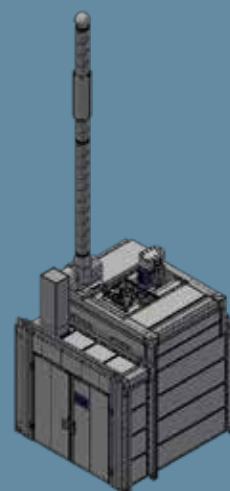

CERA-BOV-8-9-10
TOP MOUNT BURNER/
DUAL ENTRY

Rohner

FINISHING SYSTEMS™

Chris Mossman

Sales Engineer

Mobile: 503-784-8488 **Phone:** 360-885-7641 Ext 206

Email: Chrismossman@rohner-usa.com

2650 NE Andresen Rd #102

Vancouver, WA 98682

www.rohner-usa.com

Toll Free: 888-885-7641



ALSO AVAILABLE FROM ROHNER FINISHING SYSTEMS

ASSEMBLY AND INSTALLATION SERVICES

AUTOMATED HANDLING AND CONVEYOR SYSTEMS

POWDER COATING EQUIPMENT

MEDIA BLASTING EQUIPMENT AND AUTOMATION

AIR HANDLING AND AIR DRYING SYSTEMS

CLIMATE CONTROL COOLING. HEATING AND HUMIDITY CONTROL

CERAKOTE®

rohnerspraybooths.com